

ALL-IN-ONE SCREEN CLEANING SYSTEM

The award winning LensPen® technology cleans all types of small LCD or glass screens quickly and easily.

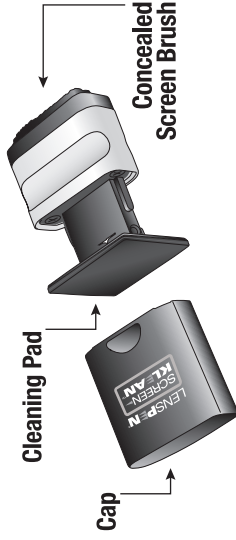

INSTRUCTIONS FOR CLEANING SCREENS

1. Turn off the computer and allow the screen to cool to room temperature.
2. Pull out the Screen Brush and rotate the brush head 180° from its original position. Push the Screen Brush back slightly and it will click into the ready-to-use position. Gently wipe dust from the screen surface and then return the Screen Brush back to its original position.
3. Prior to the first use of the ScreenKlean™ Cleaning Pad, wipe the screen surface with the Conditioning Tissue to remove any "hard" deposits. Discard the tissue after using.
4. Remove the cap to release the ScreenKlean™ Cleaning Pad. Clean fingerprints on the screen with smooth circular motions of the Cleaning Pad. Use index finger to put some pressure on the Cleaning Pad – see over.
5. If some smudges persist, breathe gently on the area to be cleaned and repeat the process.
6. Replace the cap over the Cleaning Pad.

continued over

7. Important: Do not use on wet surfaces or touch with your hands. ScreenKlean™'s cleaning compound is carbon-based, similar to a pencil lead. It leaves black marks on all surfaces which are not very, very smooth.

8. For more detailed information, please visit www.lenspen.com.

Please carefully observe the instructions for use. **IMPORTANT:** clean only when screen is dry, turned off and in cold mode. Do not use on nylon mesh or anti-glare screens.

NOTE:

Cleaning is made easier and more effective by using index finger to place some pressure on the Cleaning Pad when cleaning screen.

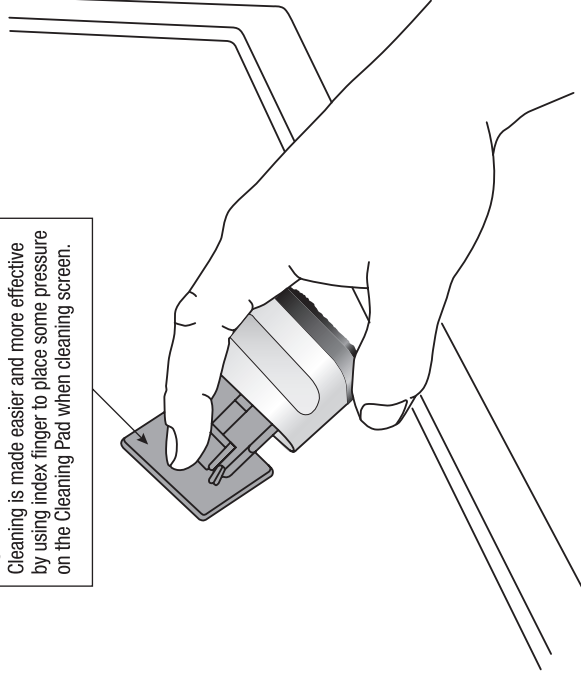

IS-167